

6-QW-45(330A), 55B24MF



The product has excellent high-current discharge characteristics and is widely used in starting, ignition, and lighting systems. It uses a grid made of lead-calcium alloy, requires no maintenance or water addition during use, has a long power storage time, and a wide applicable temperature range

PICTURE



DIMENSION

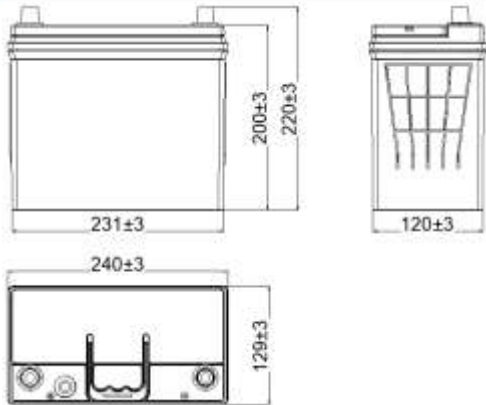

SPECIFICATION

Nominal Voltage/ V		12
Weight/±3%kg		10.5
Nominal Capacity/Ah		36
Reserve Capacity/min		53
-18℃ CCA/A		330
Max Dimensions	L/mm	240
	W/mm	129
	H/mm	200
	Total Height/mm	220
CCA		510
Temperature	Discharge/℃	-40~+60
	Charging/℃	-40~+60
	Storage/℃	-40~+60
Optimum Temperature/℃		+10~+30
Constant Charging Current/A		3.6
Constant Charging Voltage/V		13.5~13.8
Max Charging Current/A		10.8
Cover Material		PP
Executive Standard		GB/T 5008-2023

TERMINAL DIMENSION

Terminal Type	D/mm	
	Positive	Negative
T1	14.7 ⁺⁰ _{-0.3}	13.0 ⁺⁰ _{-0.3}

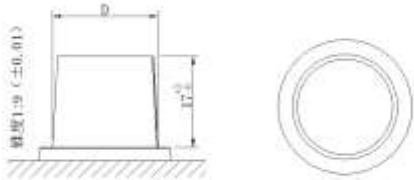

Discharge Curve / 25℃

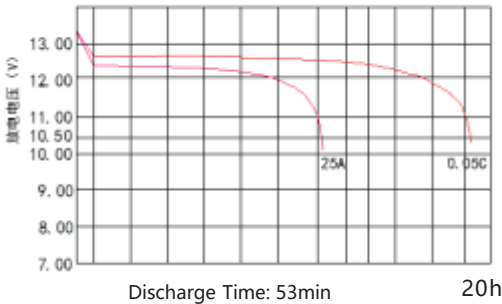

File Serial No.AKL/XC-6-QW-45T/01A